

# SUPERMAXI SERIES

## DESIGN



These up-to-date 25 and 30 nominal litres water heaters are designed with great care to details, thanks to their refined and elegant appearance; they fit well the house as part of the decor.

860 °C Bayer process enamelling of the steel boiler (according to the norm DIN 4753) plus magnesium anode ensure a long lasting protection against corrosion.

Armoured resistance in both above or below the sink models are equipped with an adjustable thermostat and with safety against over-heating.

Hydraulic safety valve is calibrated at 8 bar.

Insulation made up by polyurethane foam CFC free respects the environment.

SERIE SUPERMAXI

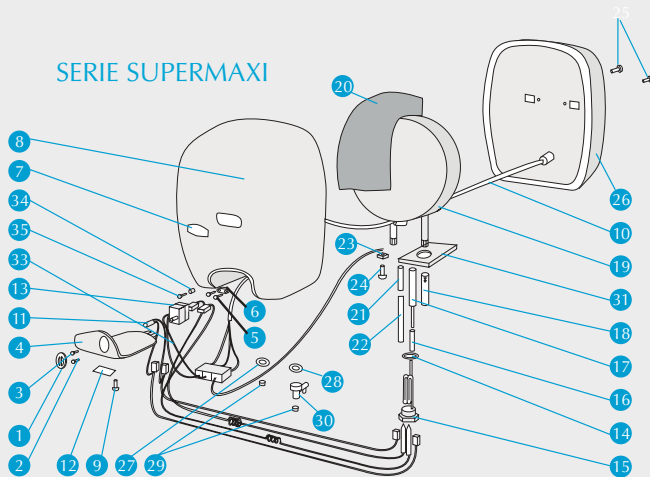

- |                                   |  |
|-----------------------------------|--|
| 1 - Thermostat knob               | 19 - Water tank                                |
| 2 - Thermostat screws             | 20 - Polyurethane foam insulation              |
| 3 - Pilot lamp                    | 21 - Adaptor                                   |
| 4 - Inspection cover              | 22 - Stainless extension for outlet water pipe |
| 5 - Screws for cable block        | 23 - Earth plate                               |
| 6 - Cable block                   | 24 - Earth screw                               |
| 7 - Brand name                    | 25 - Screw tank holder                         |
| 8 - Frontal cover                 | 26 - Back case                                 |
| 9 - Screw for inspection cover    | 27 - Red ring                                  |
| 10 - Power wire                   | 28 - Blue ring                                 |
| 11 - Wiring with pilot lamp       | 29 - Thread protection                         |
| 12 - Identification plate         | 30 - Safety and non return valve               |
| 13 - Safety thermostat            | 31 - Flexible protection                       |
| 14 - O-Ring heating element       | 32 - Chrome-plated profile                     |
| 15 - Heating element (screw type) | 33 - Cable and binding-screw                   |
| 16 - Protection for anode shank   | 34 - Lock for thermostat cables                |
| 17 - Magnesium anode              | 35 - Screw                                     |
| 18 - Jet breaker                  |  |

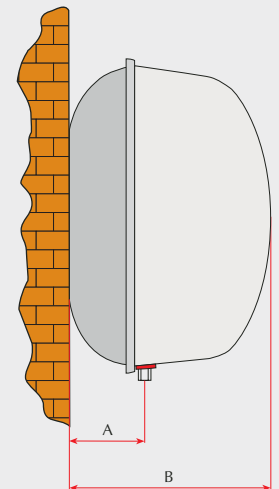
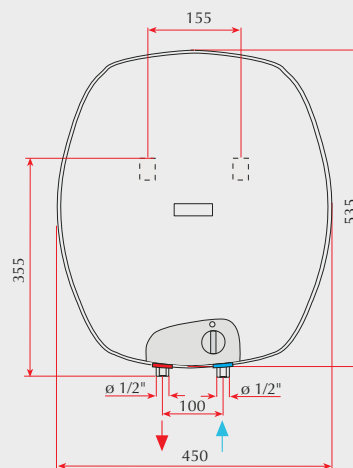

DIMENSIONS mm	SUPERMAXI 25	SUPERMAXI 30
A	90	130
B	290	330